

# A New Work Culture

PARTIAL 18TH FLOOR NEW PRE-BUILT – SUITE 1800: 6,475 RSF  
COMING SOON 7/1/2023

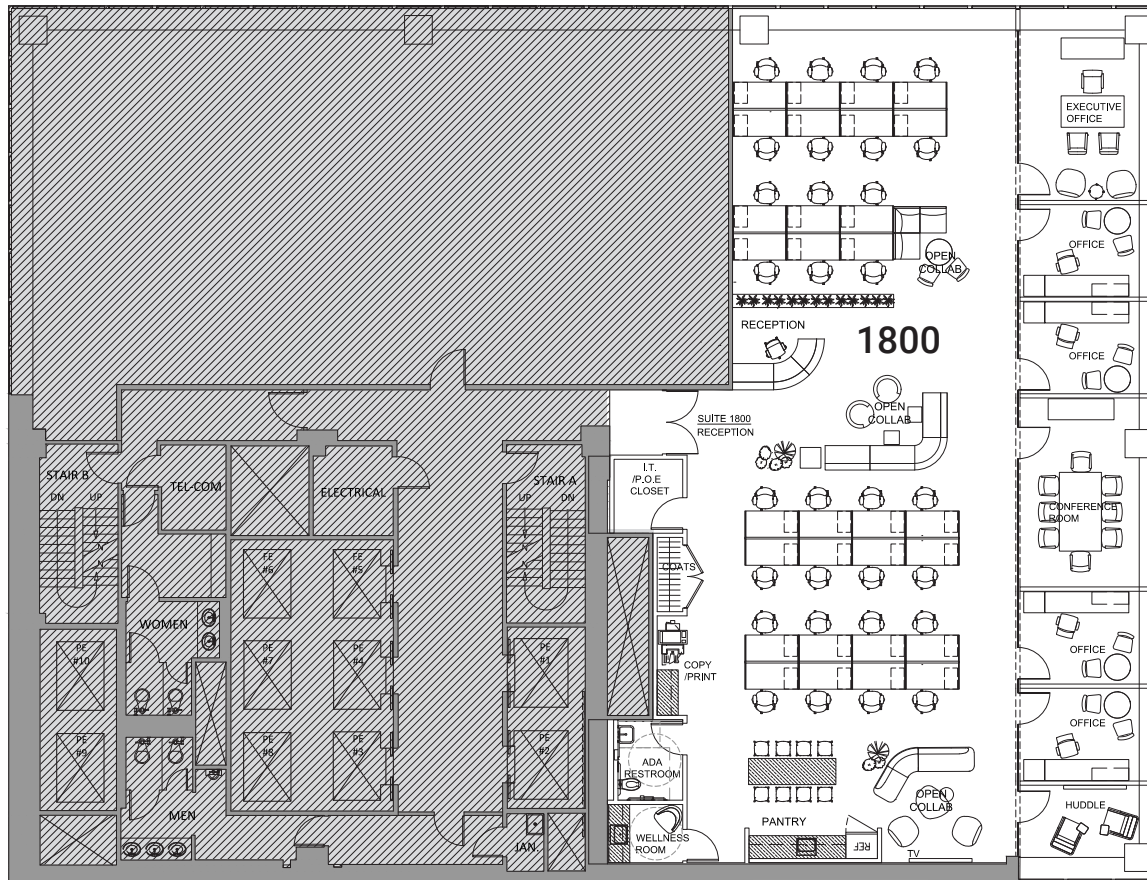

WEST 52ND STREET



FIFTH AVENUE

SUITE 1800:	
TYPE	QTY
<b>OFFICES</b>	
OFFICE	4
EXECUTIVE OFFICE	1
<b>WORKSTATIONS</b>	
WORKSTATION (5'-0" X 2'-6")	30
<b>COLLABORATION</b>	
CONFERENCE (8P)	1
Huddle	1
OPEN COLLAB.	3
<b>AMENITIES</b>	
PANTRY	1
ADA RESTROOM	1
WELLNESS ROOM	1
<b>SUPPORT &amp; STORAGE</b>	
RECEPTION	1
COPY/PRINT STATION	1
COAT CLOSET	1
I.T. /P.O.E. CLOSET	1
<b>TOTAL</b>	
HEAD COUNT	36
RSF	6,475 SF
RSF/PERSON:	180 SF

FOR LEASING INFORMATION PLEASE CONTACT:



**BARRY ZELLER**  
212-841-5913  
barry.zeller@cushwake.com

**JONATHAN FALES**  
212-841-5969  
jonathan.fales@cushwake.com

**MICHAEL TRANFALIA**  
212-841-5981  
michael.tranfalia@cushwake.com

**MICHELLE MEAN**  
212-841-7945  
michelle.mean@cushwake.com

