

Detail in Every Detail

PARTIAL 21ST FLOOR (SUITE 2100): 4,214 RSF

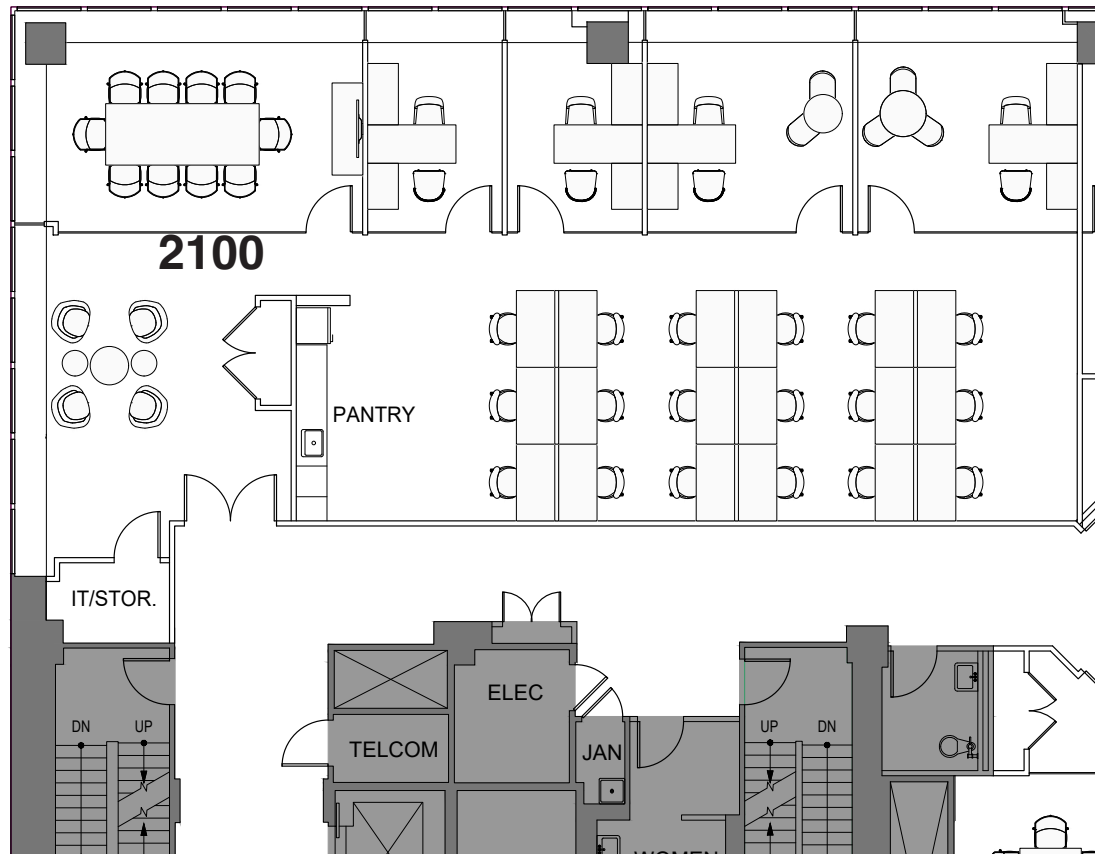

SUITE 2100 – 4,214 RSF

WORKSPACE	SEATS
PRIVATE OFFICE	4
BENCHING (5'X30")	18
TOTAL HEADCOUNT	22

COLLAB SPACE	QNTY
CONFERENCE ROOM	1

SUPPORT	QNTY
PANTRY	1
COAT CLOSET	1
COPY AREA	1
RECEPTION SEATING	1
IT /STOR	1

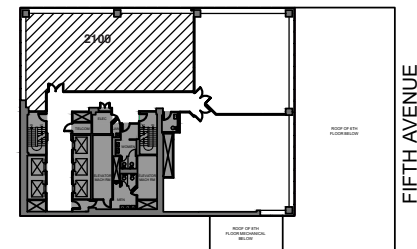

FOR LEASING INFORMATION PLEASE CONTACT:



BARRY ZELLER
212-841-5913
barry.zeller@cushwake.com

JONATHAN FALES
212-841-5969
jonathan.fales@cushwake.com

MIKE TRANFALIA
212-841-5981
michael.tranfalia@cushwake.com

MICHELLE MEAN
212-841-7945
michelle.mean@cushwake.com

