

A POWER MOVE

21ST FLOOR PRE-BUILTS:

SUITE 2100: 4,279 RSF; SUITE 2120: 2,937 RSF; SUITE 2140: 3,583 RSF

SUITE 2100 4,279 RSF		SUITE 2140 3,583 RSF	
CATEGORY	QUANTITY AS SHOWN	CATEGORY	QUANTITY AS SHOWN
OFFICE	3	OFFICE	-
BENCHING	14	BENCHING	20
RECEPTIONIST	1	RECEPTIONIST	-
TOTAL PERSONNEL	18	TOTAL PERSONNEL	20
RECEPTION AREA	1	RECEPTION AREA	1
CONF. ROOM	1	CONF. ROOM	1
PANTRY	1	PANTRY	1
COPY	1	COPY	-
COAT CLOSET	1	COAT CLOSET	1
IT ROOM	1	IT ROOM	1

SUITE 2120 2,937 RSF	
CATEGORY	QUANTITY AS SHOWN
OFFICE	2
BENCHING	12
RECEPTIONIST	-
TOTAL PERSONNEL	14
RECEPTION AREA	-
CONF. ROOM	1
PANTRY	1
COPY	-
COAT CLOSET	1
IT ROOM	1

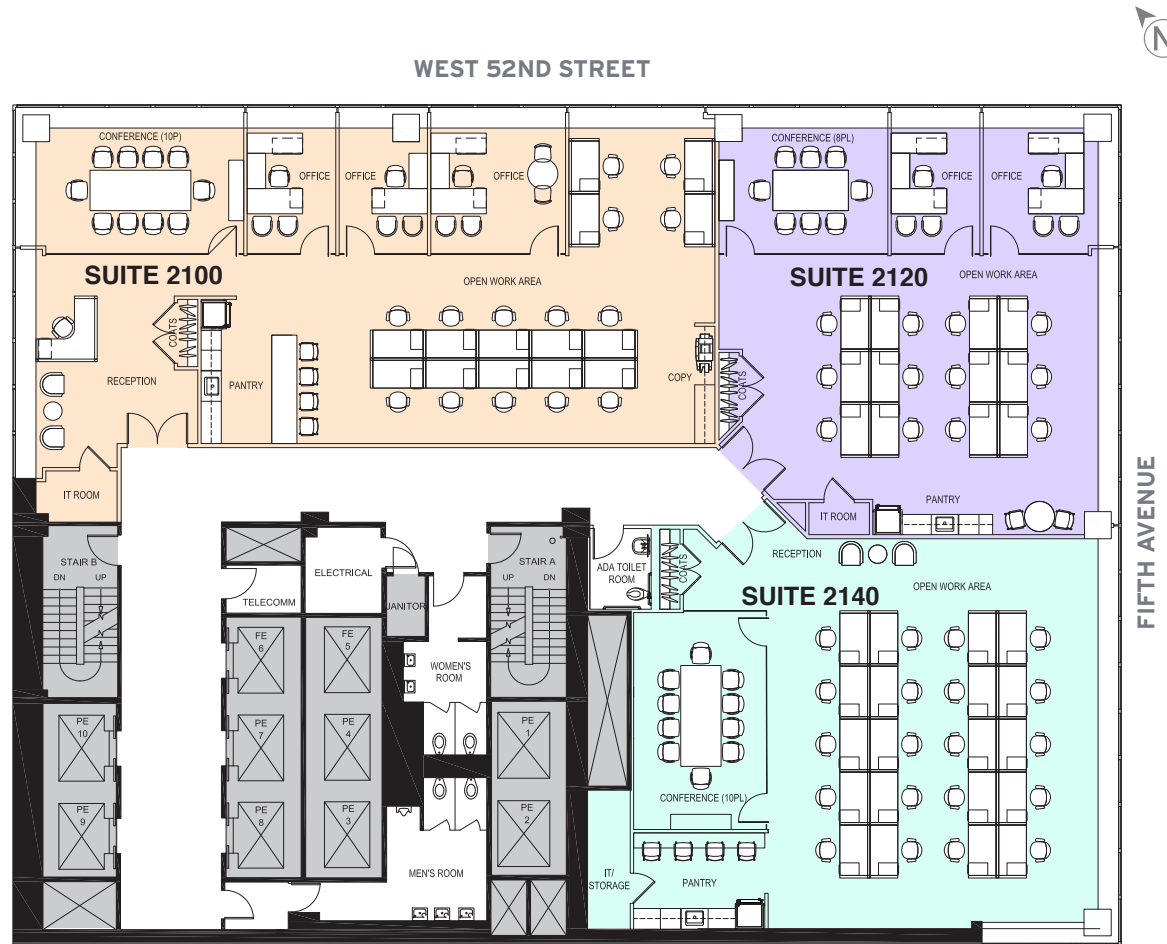

FOR LEASING INFORMATION, PLEASE CONTACT:

Barry Zeller

212.841.5913

barry.zeller@cushwake.com

Haley Fisher

212.841.7892

haley.fisher@cushwake.com

Jonathan Fales

212.841.5969

jonathan.fales@cushwake.com

Michael Tranfalia

212.841.5981

michael.tranfalia@cushwake.com

Pierce Hance

212.841.7641

pierce.hance@cushwake.com